

AW MB24

TECHNICAL DATA:

Rating: 250A CO²
220A Mixed Gases

Duty Cycle: 60%
Wire Size: 0.8 ~ 1.2MM

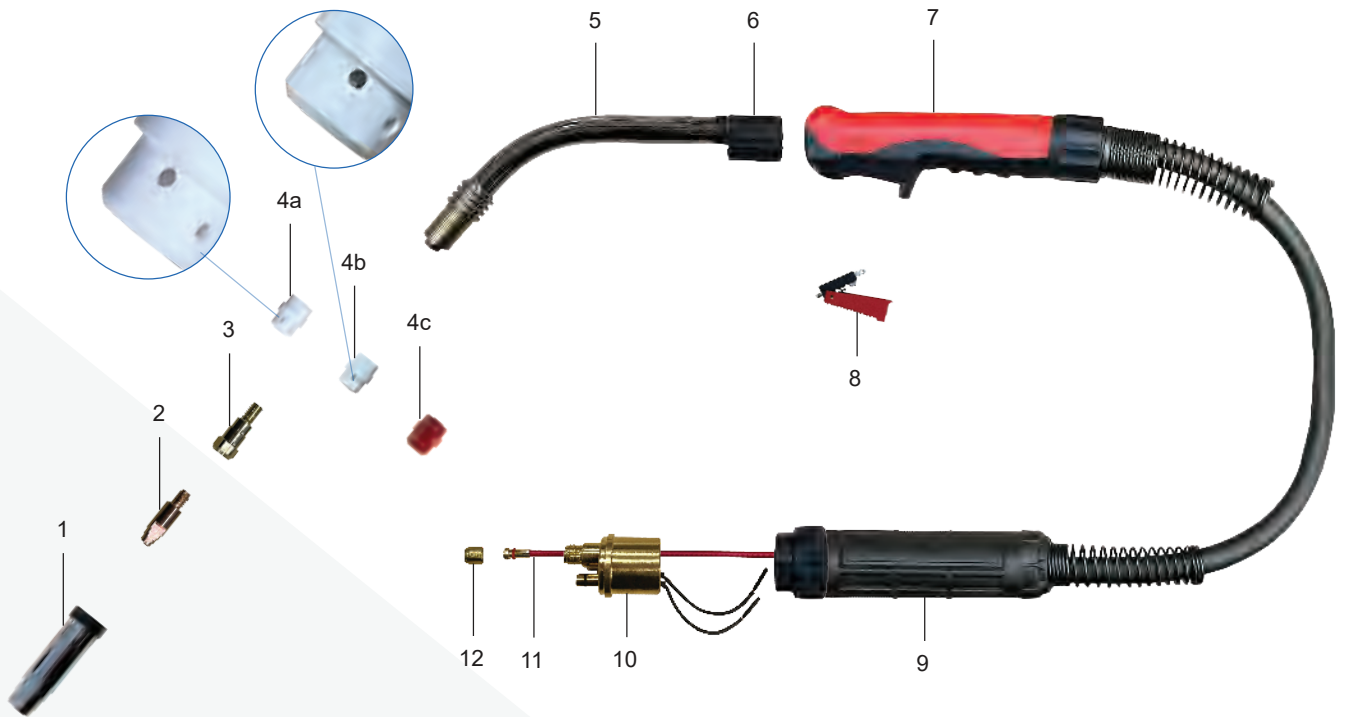

AW MB24 WELDING TORCH

Welding torch a constant voltage power supply to create an electric arc that fuses the base metal with a filler wire that is continuously fed through the welding torch.

At the same time an inert shielding gas is also fed through the gun to protect the weld pool from atmospheric contamination.

AW MB24 (COMPLETE TORCHES)

PRODUCT DESCRIPTION

MB24 MIG TORCH	3M
	4M
	5M

AW MB24 (PARTS)

PRODUCT DESCRIPTION

1	MB24 Nozzle 12.5mm
---	--------------------

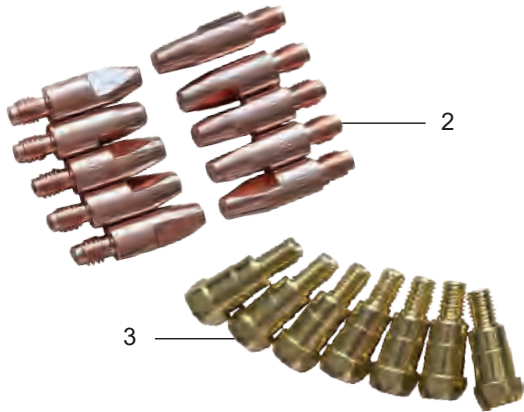

AW MB24 (PARTS)

PRODUCT DESCRIPTION

- 2 Contact Tip M6 x 28 x 0.8mm
Contact Tip M6 x 28 x 1.0mm
Contact Tip M6 x 28 x 1.2mm
Contact Tip M6 x 28 x 1.6mm
- 3 MB24 Tip Adaptor

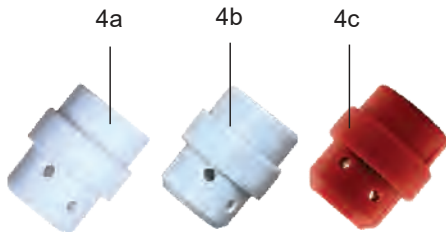

AW MB24 (PARTS)

PRODUCT DESCRIPTION

- 4a MB24 Gas Diffuser Ceramic
- 4b MB24 Gas Diffuser DMC
- 4c MB24 Gas Diffuser Silicon Rubber

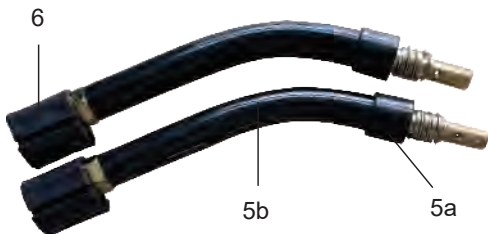

AW MB24 (PARTS)

PRODUCT DESCRIPTION

- 5a MB15 SN Front Insulation
- 5b MB15 Swan Neck c/w Tip Adapter
- 6 Swan Neck Back Insulation



AW MB24 (PARTS)

PRODUCT DESCRIPTION

- 7 AW MIG TORCH FRONT HANDLE
C/W SWITCH

AW MB24 (PARTS)

PRODUCT DESCRIPTION

- 8 MIG TRIGGER SWITCH FOR RED HANDLE
MIG TRIGGER SWITCH FOR YELLOW HANDLE
- 9 MIG TORCH BACK HANDLE (RED)
- 10 Euro Connector Torch End

PRODUCT DESCRIPTION

- 11 LINER 3M (Euro Fitting) RED
LINER 4M (Euro Fitting) RED
LINER 5M (Euro Fitting) RED
Teflon LINER 4M (Euro Fitting) BLACK
Teflon LINER 4M (Euro Fitting) GRADE C
- 12 LINER HEAD NUT