

## ANGLE-ARC K4000 GOUGING TORCH

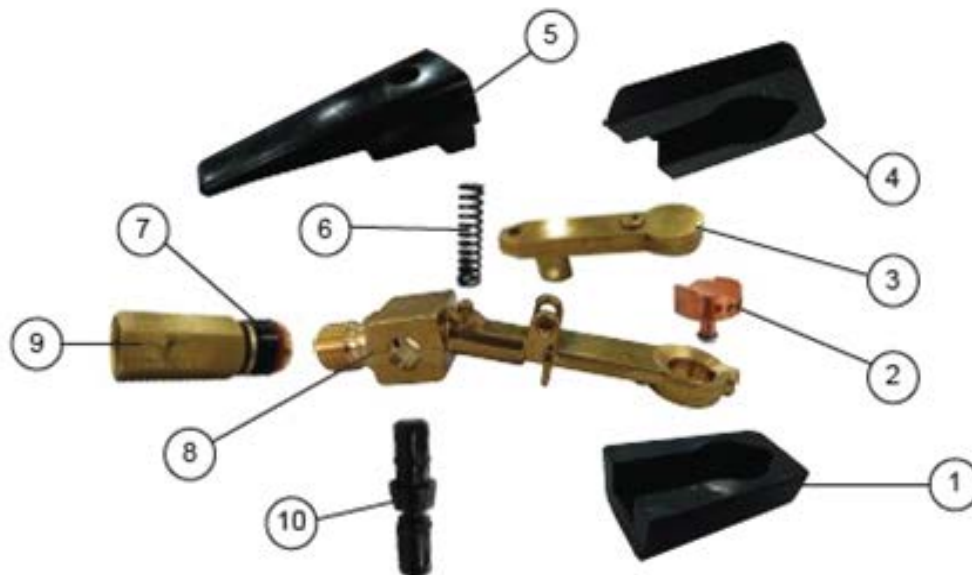

Heavy duty 1000 amp(max) torch accepts 5/32" (4.0mm) to 1/2" (12.7mm) round electrodes  
3/8" (9.5mm) & 5/8" (15.9mm) flat electrodes.



- |                 |               |
|-----------------|---------------|
| 1. Insulation   | 6. Spring     |
| 2. Head Assy    | 7. Bonnet     |
| 3. Upper Arm    | 8. Dump Arm   |
| 4. Insulation   | 9. Connector  |
| 5. Press Handle | 10. Spod Assy |